

Have You Found The Right Dollhouse Yet?

All It Takes Is BEGINNER'S LUCK™

Beginner's Luck* is a Victorian Gingerbread House.

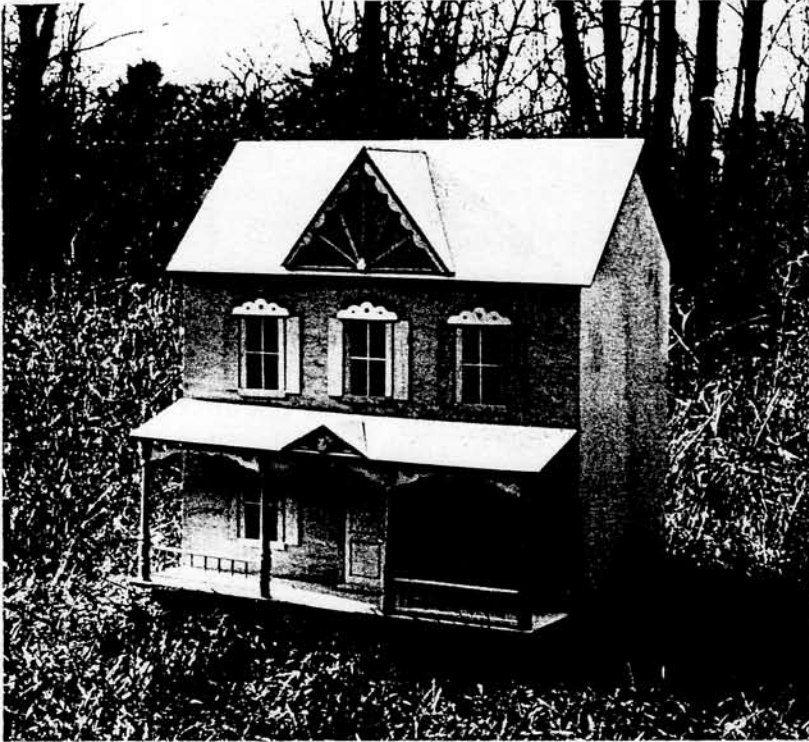

1 Beginner's Luck* is Complete with Plexiglass windows, wooden mullions, inside and outside window and door trim, a panelled door with brass hinges and knob, and shutters.

2 Beginner's Luck* is easy to assemble. Slotted and

grooved construction—created especially for this house by Real Good Toys*—makes assembly a cinch.

3 Beginner's Luck* (28" LX 28" WX 21" D) has 9 big rooms and 2 staircases. Window and door openings are cut to accommodate standard-sized components.

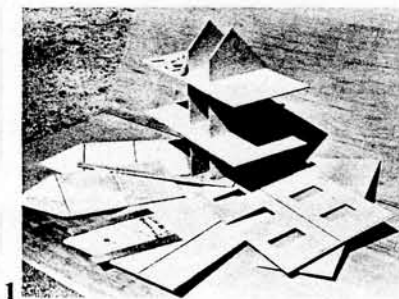

1

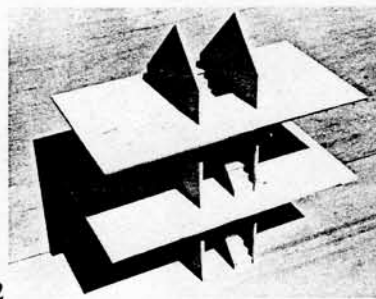

2

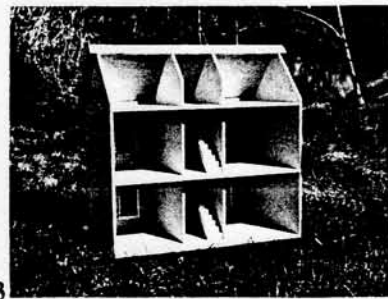

3

- Easy assembly
- All openings accept standard components
- Precision pre-cut parts
- All wood construction
- Built to last
- Handmade by Vermont Craftspeople

CALL: (802) 479-2217

Real Good Toys • 10 Quarry Hill • Barre, VT 05641

VICTORIAN GINGERBREAD (for Beginner's Luck)

1. Follow the instructions on assembling the porch.
2. Slide porch gingerbread into top grooves of porch columns. Do not force. If it's difficult, use a piece of sandpaper to make it slide in easier. There are 3 pieces. If columns are in right, there will be a groove for all of them.
3. Window gingerbread is glued to window top horizontal trim. Leave $\frac{1}{8}$ " of trim showing at bottom. Use rubber cement for maximum flexibility- you can pull it off if you want to change colors.
4. to assemble gable: Basically, this is the same process as assembling the gable of the porch...again, the triangle's bottom edge is sloped with the roof pitch, the rear edge of the roof, where the two panels meet, must be smooth.
Left panel overlaps the right panel at the peak.

To attach gingerbread, follow these steps:

1. Glue on bottom horizontal strip. (glued on ply edge)
2. Glue on center vertical strip (edge)
3. glue upper frets
4. glue on lower frets
5. glue on center piece ("button")
6. Glue on side gingerbread, making sure you have angled ends meeting at top (peak). If they don't seem to fit right, turn them around- you may have the wrong angles at top.

Center peak on roof, then glue at vertical height of your choice.

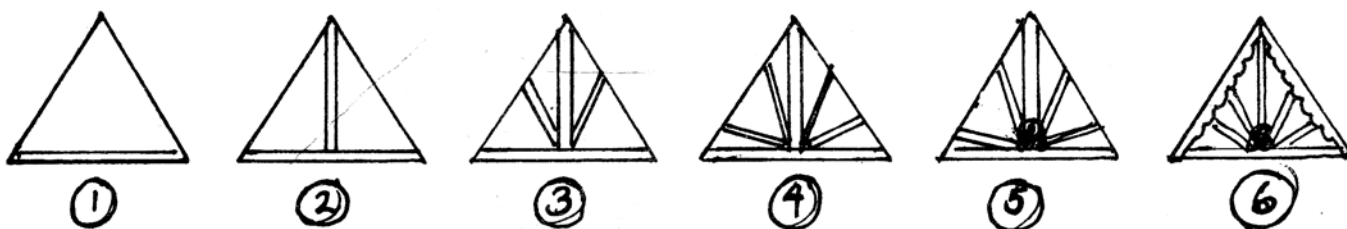
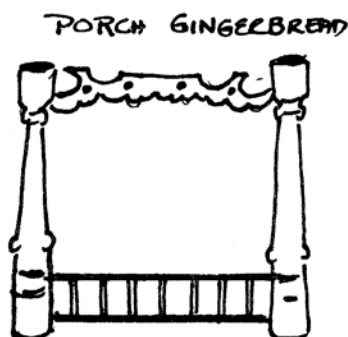

PARTS: 5 window gingerbread, 3 porch gingerbread, left roof panel, right roof panel, center roof panel, bottom horiz. strip, ctr. vertical strip, 2 upper frets, 2 lower frets, ctr. piece, 2 side gingerbread pieces.